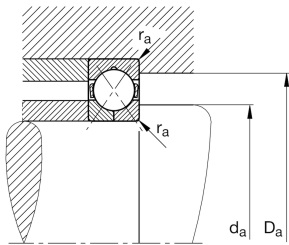
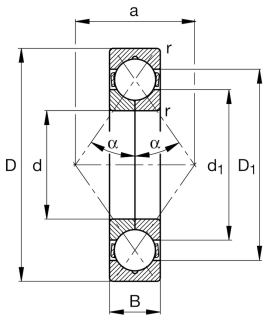

**FAG****QJ1252-MPA**

Four-point contact bearing

Four point contact bearing QJ12...-MPA, solid brass cage

## Technical information

**Your current product variant**

Cage	MPA	Solid brass cage, outer ring guided
Tolerance class	PN	Tolerance class PN, acc. to DIN 620
Dimensional / heat stabilization	S1	Rings dimensional stabilized up to 200°
Axial internal clearance	CN	Group N (CN)

**Main Dimensions & Performance Data**

d	260 mm	Bore diameter
D	480 mm	Outside diameter
B	90 mm	Width
$C_r$	760.000 N	Basic dynamic load rating, radial
$C_{0r}$	1.480.000 N	Basic static load rating, radial
$C_{ur}$	43.500 N	Fatigue load limit, radial
$n_G$	2.360 1/min	Limiting speed
$n_{gr}$	1.210 1/min	Reference speed
$m$	77,6 kg	Weight

**Mounting dimensions**

$d_{a \min}$	280 mm	Minimum diameter shaft shoulder
$D_{a \max}$	460 mm	Maximum diameter of housing shoulder
$r_{a \max}$	4 mm	Maximum fillet radius







## Dimensions

$r_{\min}$	5 mm	Minimum chamfer dimension
$D_1$	398,2 mm	Shoulder diameter outer ring
$d_1$	342,45 mm	Shoulder diameter inner ring
$a$	370 mm	Distance between the apexes of the pressure cones
$\alpha$	45 °	Contact angle

## Temperature range

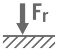
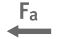
$T_{\min}$	-30 °C	Operating temperature min.
$T_{\max}$	200 °C	Operating temperature max.

## Characteristics

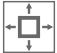
	Radial load
	Axial load in one direction
	Axial load in two directions
	Grease Lubrication
	Oil Lubrication
	Not sealed
	Large bearing