

**CSXA020**

Four-point contact bearing

Four point contact bearing, Thin section bearing CSXA, brass sheet metal cage

Technical information

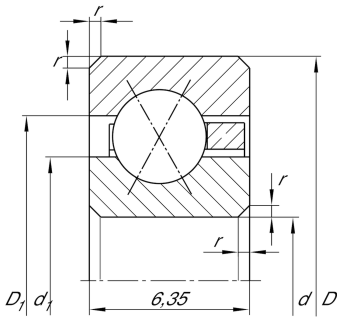

Your current product variant

Logistical code	HLE	-
Cage	YH	Brass sheet metal
Radial internal clearance	PL1	Class PL1, Normal
Lubricant	Without	Bearing not greased

Main Dimensions & Performance Data

d	50,8 mm	Bore diameter
D	63,5 mm	Outside diameter
B	6,35 mm	Width
C_r	4.400 N	Basic dynamic load rating, radial
C_{0r}	4.600 N	Basic static load rating, radial
n_G	6.900 1/min	Limiting speed
m	50 g	Weight

Dimensions

r_{min}	0,6 mm	Minimum chamfer dimension
d_1	55,5 mm	Shoulder diameter inner ring
D_1	58,8 mm	Shoulder diameter outer ring
α	30 °	Contact angle



Temperature range

T_{\min}	-30 °C	Operating temperature min.
T_{\max}	120 °C	Operating temperature max.

Characteristics



Radial load



Axial load in one direction



Axial load in two directions



Grease Lubrication



Oil Lubrication



Not sealed