

**FAG****NNU41/500-M**

Cylindrical roller bearing

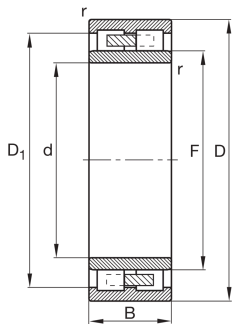

Technical information

**Your current product variant**

| | | |
|---------------------------|--------------|---------------------------|
| Cage | M | Brass Cage |
| Tolerance class | PN | Normal (ISO 492:2014) |
| Radial internal clearance | CN (Group N) | Normal internal clearance |
| Number of rows | 2 | Double-row design |

Main Dimensions & Performance Data

| | | |
|-----------------|--------------|---------------------------------------|
| d | 500 mm | Bore diameter |
| D | 830 mm | Outside diameter |
| B | 325 mm | Width |
| C_r | 7.200.000 N | Basic dynamic load rating, radial |
| C_{0r} | 14.700.000 N | Basic static load rating, radial |
| C_{ur} | 1.290.000 N | Fatigue load limit, radial |
| n_G Grease | 1.000 1/min | Limiting speed for grease lubrication |
| $n_{G\ Oil}$ | 1.180 1/min | Limiting speed for oil lubrication |
| $\approx m$ | 710 kg | Weight |

Mounting dimensions

| | | |
|---------------|--------|------------------------------|
| d_a | 532 mm | Diameter shaft shoulder |
| D_a | 798 mm | Diameter of housing shoulder |
| $r_{a1\ max}$ | 6 mm | Maximum recess radius |

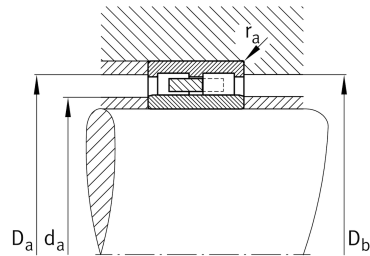



Dimensions

| | | |
|--------------------|---------|------------------------------|
| r _{1 min} | 7,5 mm | Minimum chamfer dimension |
| F | 582 mm | Raceway diameter inner ring |
| s | 11,7 mm | Axial displacement |
| D ₁ | 725 mm | Shoulder diameter outer ring |

Temperature range

| | | |
|------------------|--------|----------------------------|
| T _{min} | -30 °C | Operating temperature min. |
| T _{max} | 150 °C | Operating temperature max. |

Characteristics



Large bearing