

**FAG****NNU4152-M**

Cylindrical roller bearing

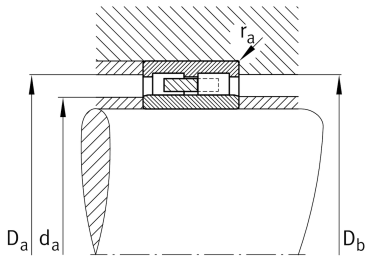

Technical information

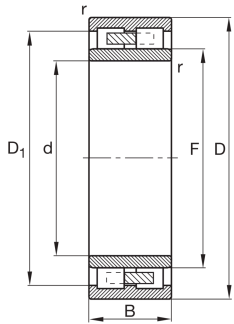

Your current product variant

Cage	M	Brass Cage
Tolerance class	PN	Normal (ISO 492:2023)
Radial internal clearance	CN (Group N)	Normal internal clearance
Number of rows	2	Double-row design

Main Dimensions & Performance Data

d	260 mm	Bore diameter
D	440 mm	Outside diameter
B	180 mm	Width
C_r	2.360.000 N	Basic dynamic load rating, radial
C_{0r}	4.450.000 N	Basic static load rating, radial
C_{ur}	510.000 N	Fatigue load limit, radial
n_G Grease	2.000 1/min	Limiting speed for grease lubrication
$n_{G\ Oil}$	2.360 1/min	Limiting speed for oil lubrication
$\approx m$	113,8 kg	Weight

Mounting dimensions

d_a	277 mm	Diameter shaft shoulder
D_a	423 mm	Diameter of housing shoulder
$r_{a1\ max}$	3 mm	Maximum recess radius



Dimensions

r _{1 min}	4 mm	Minimum chamfer dimension
F	306 mm	Raceway diameter inner ring
s	7,7 mm	Axial displacement
D ₁	381,2 mm	Shoulder diameter outer ring

Temperature range

T _{min}	-30 °C	Operating temperature min.
T _{max}	150 °C	Operating temperature max.

Characteristics



Large bearing