

**FAG****NNU4156-M**

Cylindrical roller bearing

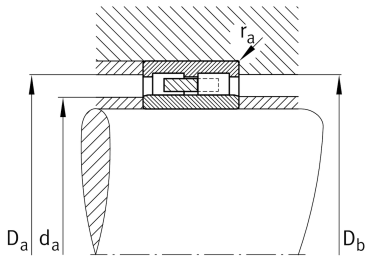

Technical information

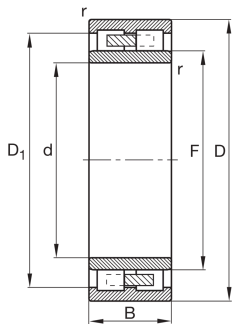

Your current product variant

Cage	M	Brass Cage
Tolerance class	PN	Normal (ISO 492:2023)
Radial internal clearance	CN (Group N)	Normal internal clearance
Number of rows	2	Double-row design

Main Dimensions & Performance Data

d	280 mm	Bore diameter
D	460 mm	Outside diameter
B	180 mm	Width
C_r	2.430.000 N	Basic dynamic load rating, radial
C_{0r}	4.700.000 N	Basic static load rating, radial
C_{ur}	530.000 N	Fatigue load limit, radial
n_G Grease	1.920 1/min	Limiting speed for grease lubrication
$n_{G\ Oil}$	2.260 1/min	Limiting speed for oil lubrication
$\approx m$	116,52 kg	Weight

Mounting dimensions

d_a	300 mm	Diameter shaft shoulder
D_a	440 mm	Diameter of housing shoulder
$r_{a1\ max}$	4 mm	Maximum recess radius



Dimensions

r _{1 min}	5 mm	Minimum chamfer dimension
F	326 mm	Raceway diameter inner ring
s	5 mm	Axial displacement
D ₁	401,2 mm	Shoulder diameter outer ring

Temperature range

T _{min}	-30 °C	Operating temperature min.
T _{max}	150 °C	Operating temperature max.

Characteristics



Large bearing