

**FAG****NNU4156-M-C3**

Cylindrical roller bearing

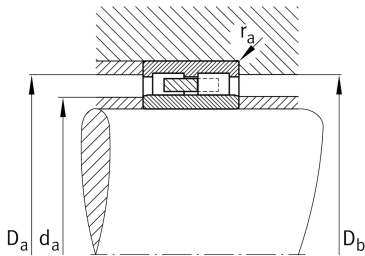
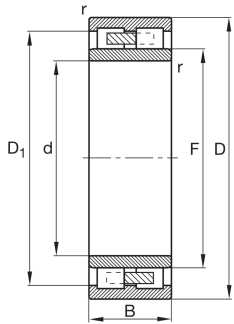

## Technical information

**Your current product variant**

Cage	M	Brass Cage
Tolerance class	PN	Normal (ISO 492:2023)
Number of rows	2	Double-row design

**Main Dimensions & Performance Data**

d	280 mm	Bore diameter
D	460 mm	Outside diameter
B	180 mm	Width
$C_r$	2.430.000 N	Basic dynamic load rating, radial
$C_{0r}$	4.700.000 N	Basic static load rating, radial
$C_{ur}$	530.000 N	Fatigue load limit, radial
$n_G$ Grease	1.920 1/min	Limiting speed for grease lubrication
$n_G$ Oil	2.260 1/min	Limiting speed for oil lubrication
$\approx m$	116,52 kg	Weight

**Mounting dimensions**

$d_a$	300 mm	Diameter shaft shoulder
$D_a$	440 mm	Diameter of housing shoulder
$r_{a1 \max}$	4 mm	Maximum recess radius



### Dimensions

$r_1 \text{ min}$	5 mm	Minimum chamfer dimension
F	326 mm	Raceway diameter inner ring
s	5 mm	Axial displacement
$D_1$	401,2 mm	Shoulder diameter outer ring

### Temperature range

$T_{\text{min}}$	-30 °C	Operating temperature min.
$T_{\text{max}}$	150 °C	Operating temperature max.

### Characteristics



Large bearing