

**FAG****NNU4180-S-M-C3**

Cylindrical roller bearing

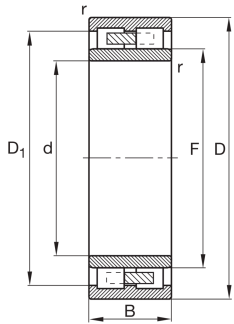

Technical information

**Your current product variant**

Cage	M	Brass Cage
Tolerance class	PN	Normal (ISO 492:2023)
Number of rows	2	Double-row design

Main Dimensions & Performance Data

d	400 mm	Bore diameter
D	650 mm	Outside diameter
B	250 mm	Width
C_r	4.850.000 N	Basic dynamic load rating, radial
C_{0r}	9.600.000 N	Basic static load rating, radial
C_{ur}	900.000 N	Fatigue load limit, radial
n_G Grease	1.280 1/min	Limiting speed for grease lubrication
n_G Oil	1.510 1/min	Limiting speed for oil lubrication
$\approx m$	321,85 kg	Weight

Mounting dimensions

d_a	426 mm	Diameter shaft shoulder
D_a	624 mm	Diameter of housing shoulder
$r_{a1 \max}$	5 mm	Maximum recess radius

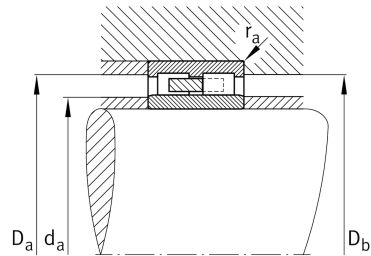



Dimensions

r _{1 min}	6 mm	Minimum chamfer dimension
F	463 mm	Raceway diameter inner ring
s	11,4 mm	Axial displacement
D ₁	577 mm	Shoulder diameter outer ring

Temperature range

T _{min}	-30 °C	Operating temperature min.
T _{max}	150 °C	Operating temperature max.

Characteristics



Large bearing