

**FAG****NNU4184-M**

Cylindrical roller bearing

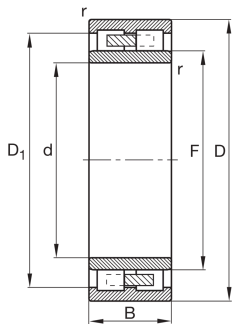

## Technical information



## Your current product variant

Cage	M	Brass Cage
Tolerance class	PN	Normal (ISO 492:2014)
Radial internal clearance	CN (Group N)	Normal internal clearance
Number of rows	2	Double-row design

## Main Dimensions &amp; Performance Data

d	420 mm	Bore diameter
D	700 mm	Outside diameter
B	280 mm	Width
$C_r$	5.500.000 N	Basic dynamic load rating, radial
$C_{0r}$	10.900.000 N	Basic static load rating, radial
$C_{ur}$	990.000 N	Fatigue load limit, radial
$n_G$ Grease	1.200 1/min	Limiting speed for grease lubrication
$n_G$ Oil	1.420 1/min	Limiting speed for oil lubrication
$\approx m$	426,04 kg	Weight

## Mounting dimensions

$d_a$	446 mm	Diameter shaft shoulder
$D_a$	674 mm	Diameter of housing shoulder
$r_{a1 \max}$	5 mm	Maximum recess radius

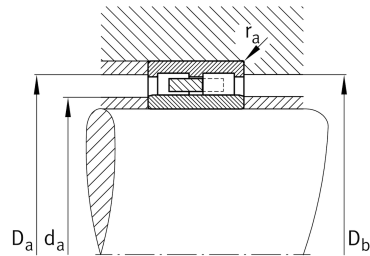



### Dimensions

---

r <sub>1 min</sub>	6 mm	Minimum chamfer dimension
F	491 mm	Raceway diameter inner ring
s	8,7 mm	Axial displacement
D <sub>1</sub>	612 mm	Shoulder diameter outer ring

### Temperature range

---

T <sub>min</sub>	-30 °C	Operating temperature min.
T <sub>max</sub>	150 °C	Operating temperature max.

### Characteristics

---



Large bearing