

**HK1416-2RS-AS1-L271** [↗](#)

Drawn cup needle roller bearing open end

Drawn cup needle roller bearing open end
HK...-2RS-AS1, single row, with cage

Technical information

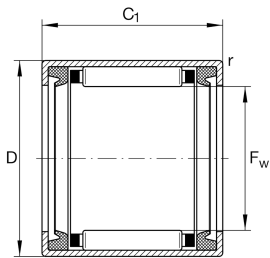

Your current product variant

Lubricant	L271	Grease (L271/standart specific)
Lubrication hole	AS1	With (1)
Coating	Without	
Type of Seal	2RS	Contact seal on both sides

Main Dimensions & Performance Data

F_w	14 mm	Under roller diameter
D	20 mm	Outside diameter
C_r	7.100 N	Basic dynamic load rating, radial
C_{0r}	8.500 N	Basic static load rating, radial
C_{ur}	1.030 N	Fatigue load limit, radial
n_G	10.500 1/min	Limiting speed
n_G Grease	10.500 1/min	Limiting speed for grease lubrication
m	11,865 g	Weight

Dimensions

C_1	16 mm	Width, outer ring
r_{min}	0,8 mm	Minimum chamfer dimension

Temperature range

T_{min}	-20 °C	Operating temperature min.
T_{max}	100 °C	Operating temperature max.