

**HK2524-2RS-AS1-L271** [↗](#)

Drawn cup needle roller bearing open end

Drawn cup needle roller bearing open end
HK...-2RS-AS1, single row, with cage

Technical information

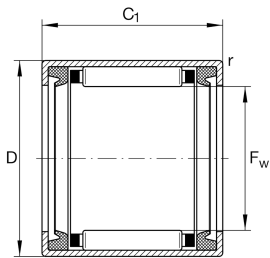

Your current product variant

Lubricant	L271	Grease (L271/standart specific)
Lubrication hole	AS1	With (1)
Coating	Without	
Sealing	2RS	Contact seal on both sides

Main Dimensions & Performance Data

F_w	25 mm	Under roller diameter
D	32 mm	Outside diameter
C_r	19.900 N	Basic dynamic load rating, radial
C_{0r}	33.000 N	Basic static load rating, radial
C_{ur}	4.300 N	Fatigue load limit, radial
n_G	6.100 1/min	Limiting speed
n_G Grease	6.100 1/min	Limiting speed for grease lubrication
m	38,16 g	Weight

Dimensions

C_1	24 mm	Width, outer ring
r_{min}	0,8 mm	Minimum chamfer dimension

Temperature range

T_{min}	-20 °C	Operating temperature min.
T_{max}	100 °C	Operating temperature max.