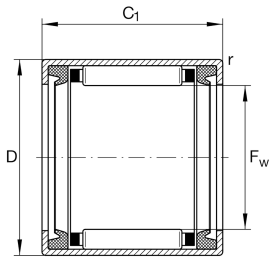

**HK2530-2RS-RR-L271** [↗](#)

Drawn cup needle roller bearing open end

Drawn cup needle roller bearing open end
HK...-2RS-RR, single row, with cage

Technical information

**Your current product variant**

Lubricant	L271	Grease (L271/standart specific)
Lubrication hole	Without	
Coating	RR	Protected against corrosion by Corrotect special coating
Sealing	2RS	Contact seal on both sides

Main Dimensions & Performance Data

F_w	25 mm	Under roller diameter
D	32 mm	Outside diameter
C_r	25.500 N	Basic dynamic load rating, radial
C_{0r}	45.000 N	Basic static load rating, radial
C_{ur}	6.300 N	Fatigue load limit, radial
n_G	6.100 1/min	Limiting speed
n_G Grease	6.100 1/min	Limiting speed for grease lubrication
m	48,62 g	Weight

Dimensions

C_1	30 mm	Width, outer ring
r_{min}	0,8 mm	Minimum chamfer dimension



Temperature range

T _{min}	-20 °C	Operating temperature min.
------------------	--------	----------------------------

T _{max}	100 °C	Operating temperature max.
------------------	--------	----------------------------

Additional information

IR20X25X30-XL

Suitable inner rings IR