

**HK0810-B-L271** [↗](#)

Drawn cup needle roller bearing open end

Drawn cup needle roller bearings with open ends HK, to DIN 618/ISO 3245

## Technical information

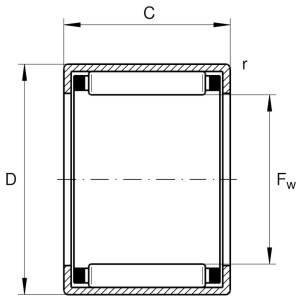

## Your current product variant

Lubricant	L271	Grease (L271/standart specific)
Lubrication hole	Without	
Coating	Without	
Sealing	Without	

## Main Dimensions &amp; Performance Data

$F_w$	8 mm	Under roller diameter
D	12 mm	Outside diameter
C	10 mm	Width
$C_r$	3.800 N	Basic dynamic load rating, radial
$C_{0r}$	3.950 N	Basic static load rating, radial
$C_{ur}$	510 N	Fatigue load limit, radial
$n_G$	29.500 1/min	Limiting speed
$n_{G \text{ Grease}}$	17.700 1/min	Limiting speed for grease lubrication
$n_{gr}$	23.200 1/min	Reference speed
$\approx m$	3,26 g	Weight

## Dimensions

$r_{\min}$	0,4 mm	Minimum chamfer dimension
------------	--------	---------------------------



### Temperature range

$T_{\min}$	-30 °C	Operating temperature min.
$T_{\max}$	140 °C	Operating temperature max.

### Additional information

G8X12X3	Sealing ring 2
IR5X8X12-XL	Suitable inner rings IR

### Characteristics

-  Radial load
-  Grease Lubrication
-  Oil Lubrication
-  Not sealed
-  Small design envelope