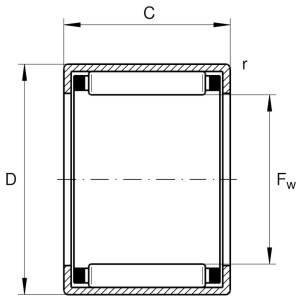

**HK1212-RR-B**

Drawn cup needle roller bearing open end

Drawn cup needle roller bearing open end  
HK...RR-B, single row, with cage

## Technical information

**Your current product variant**

|                  |         |  |
|------------------|---------|--|
| Lubricant        | Without |  |
| Lubrication hole | Without |  |
| Coating          | RR      | Protected against corrosion by Corrotect special coating |
| Sealing          | Without |  |

**Main Dimensions & Performance Data**

|                 |              |                                       |
|-----------------|--------------|---------------------------------------|
| $F_w$           | 12 mm        | Under roller diameter                 |
| D               | 18 mm        | Outside diameter                      |
| C               | 12 mm        | Width                                 |
| $C_r$           | 6.500 N      | Basic dynamic load rating, radial     |
| $C_{0r}$        | 7.300 N      | Basic static load rating, radial      |
| $C_{ur}$        | 880 N        | Fatigue load limit, radial            |
| $n_G$           | 20.000 1/min | Limiting speed                        |
| $n_G$<br>Grease | 12.000 1/min | Limiting speed for grease lubrication |
| $n_{gr}$        | 15.500 1/min | Reference speed                       |
| $m$             | 8,888 g      | Weight                                |

**Dimensions**

|           |        |                           |
|-----------|--------|---------------------------|
| $r_{min}$ | 0,8 mm | Minimum chamfer dimension |
|-----------|--------|---------------------------|



### Temperature range

|                  |        |                            |
|------------------|--------|----------------------------|
| T <sub>min</sub> | -30 °C | Operating temperature min. |
| T <sub>max</sub> | 140 °C | Operating temperature max. |

### Additional information

|                |                         |
|----------------|-------------------------|
| SD12X18X3      | Sealing ring            |
| G12X18X3       | Sealing ring 2          |
| LR8X12X12,5    | Suitable inner rings LR |
| IR8X12X12,5-XL | Suitable inner rings IR |