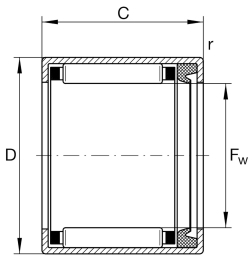

**HK2518-RS**

## Drawn cup needle roller bearing open end

Drawn cup needle roller bearings with open ends HK..-RS, lip seal on one side, to DIN 618

## Technical information

**Your current product variant**

Lubricant	L271	Grease (L271/standart specific)
Lubrication hole	Without	
Coating	Without	
Sealing	RS	Contact seal on one sides

**Main Dimensions & Performance Data**

$F_w$	25 mm	Under roller diameter
D	32 mm	Outside diameter
C	18 mm	Width
$C_r$	15.600 N	Basic dynamic load rating, radial
$C_{0r}$	24.000 N	Basic static load rating, radial
$C_{ur}$	3.200 N	Fatigue load limit, radial
$n_G$	6.100 1/min	Limiting speed
$n_G$ Grease	6.100 1/min	Limiting speed for grease lubrication
$m$	28,965 g	Weight

**Dimensions**

$r_{min}$	0,8 mm	Minimum chamfer dimension
-----------	--------	---------------------------

**Temperature range**

$T_{min}$	-20 °C	Operating temperature min.
$T_{max}$	100 °C	Operating temperature max.





### Additional information

---

LR20X25X20,5	Suitable inner rings LR
IR20X25X20-XL	Suitable inner rings IR

### Characteristics

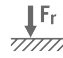
---

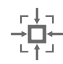
-  Radial load
-  Grease Lubrication
-  Sealed on one side
-  Small design envelope