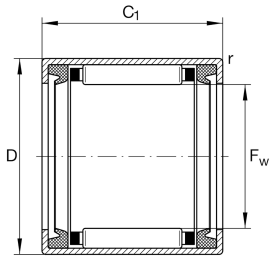
**HK1216-2RS-AS1-L271** [↗](#)

Drawn cup needle roller bearing open end

Drawn cup needle roller bearings with open ends HK..-2RS, lip seals on both sides, to DIN 618

Technical information

**Your current product variant**

Lubricant	L271	Grease (L271/standart specific)
Lubrication hole	Without	
Coating	Without	
Type of seal	2RS	Contact seal on both sides

Main Dimensions & Performance Data

F_w	12 mm	Under roller diameter
D	18 mm	Outside diameter
C_r	6.500 N	Basic dynamic load rating, radial
C_{0r}	7.300 N	Basic static load rating, radial
C_{ur}	880 N	Fatigue load limit, radial
n_G	12.000 1/min	Limiting speed
n_G Grease	12.000 1/min	Limiting speed for grease lubrication
$\approx m$	11,17 g	Weight

Dimensions

C_1	16 mm	Width, outer ring
r_{min}	0,8 mm	Minimum chamfer dimension

Temperature range

T_{min}	-20 °C	Operating temperature min.
T_{max}	100 °C	Operating temperature max.



Additional information

IR9X12X16-XL

Suitable inner rings IR

Characteristics

-  Radial load
-  Grease Lubrication
-  Sealed on both sides
-  Small design envelope