

**BK0609** [↗](#)

## Drawn cup needle roller bearing closed end

Drawn cup needle roller bearings with closed end BK, to DIN 618/ISO 3245

## Technical information

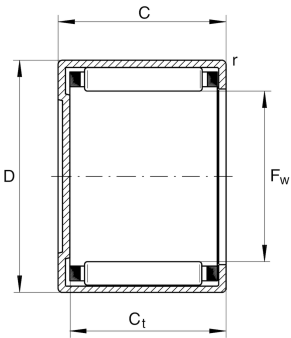

## Your current product variant

Lubricant	Without
Lubrication hole	Without
Coating	Without
Sealing	Without

## Main Dimensions &amp; Performance Data

$F_w$	6 mm	Under roller diameter
D	10 mm	Outside diameter
C	9 mm	Width, outer ring
$C_r$	2.850 N	Basic dynamic load rating, radial
$C_{0r}$	2.600 N	Basic static load rating, radial
$C_{ur}$	320 N	Fatigue load limit, radial
$n_G$ Grease	21.900 1/min	Limiting speed for grease lubrication
$n_G$	36.500 1/min	Limiting speed
$n_{gr}$	30.500 1/min	Reference speed
$\approx m$	2,425 g	Weight

## Dimensions

$r_{min}$	0,4 mm	Minimum chamfer dimension
$C_{tmin}$	7,4 mm	Minimum width to base of drawn cup with closed end







### Temperature range

$T_{min}$	-30 °C	Operating temperature min.
$T_{max}$	140 °C	Operating temperature max.

### Additional information

GR6X10X2	Sealing ring
----------	--------------

### Characteristics

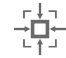
-  Radial load
-  Grease Lubrication
-  Oil Lubrication
-  Not sealed
-  Small design envelope