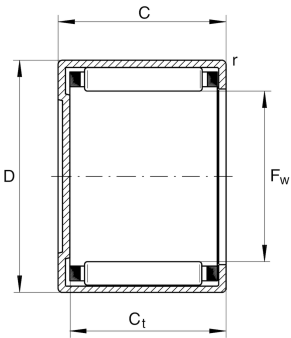

**BK0609-B-L294** [↗](#)

Drawn cup needle roller bearing closed end

Drawn cup needle roller bearings with closed end BK, to DIN 618/ISO 3245

Technical information

**Your current product variant**

Lubricant	L294	Grease (L294/customer specific)
Lubrication hole	Without	
Coating	Without	
Sealing	Without	

Main Dimensions & Performance Data

F_w	6 mm	Under roller diameter
D	10 mm	Outside diameter
C	9 mm	Width, outer ring
C_r	2.850 N	Basic dynamic load rating, radial
C_{0r}	2.600 N	Basic static load rating, radial
C_{ur}	320 N	Fatigue load limit, radial
n_G Grease	21.900 1/min	Limiting speed for grease lubrication
n_G	36.500 1/min	Limiting speed
n_{gr}	30.500 1/min	Reference speed
$\approx m$	2,6 g	Weight

Dimensions

r_{min}	0,4 mm	Minimum chamfer dimension
C_{tmin}	7,4 mm	Minimum width to base of drawn cup with closed end



Temperature range

T_{min}	-30 °C	Operating temperature min.
T_{max}	140 °C	Operating temperature max.

Additional information

GR6X10X2	Sealing ring
----------	--------------

Characteristics

-  Radial load
-  Grease Lubrication
-  Oil Lubrication
-  Not sealed
-  Small design envelope