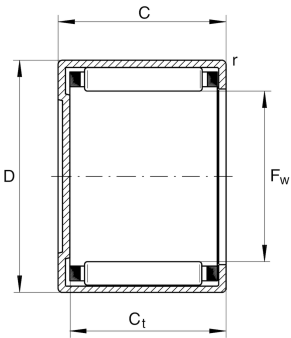

**BK0810-B-L294** [🔗](#)

Drawn cup needle roller bearing closed end

Drawn cup needle roller bearings with closed end BK, to DIN 618/ISO 3245

Technical information

**Your current product variant**

Lubricant	L294	Grease (L294/customer specific)
Lubrication hole	Without	
Coating	Without	
Type of Seal	Without	

Main Dimensions & Performance Data

F_w	8 mm	Under roller diameter
D	12 mm	Outside diameter
C	10 mm	Width, outer ring
C_r	3.800 N	Basic dynamic load rating, radial
C_{0r}	3.950 N	Basic static load rating, radial
C_{ur}	510 N	Fatigue load limit, radial
n_G Grease	17.700 1/min	Limiting speed for grease lubrication
n_G	29.500 1/min	Limiting speed
n_{gr}	23.200 1/min	Reference speed
$\approx m$	3,4 g	Weight

Dimensions

r_{min}	0,4 mm	Minimum chamfer dimension
C_{tmin}	8,4 mm	Minimum width to base of drawn cup with closed end



Temperature range

T_{\min}	-30 °C	Operating temperature min.
T_{\max}	140 °C	Operating temperature max.

Additional information

G8X12X3	Sealing ring 2
IR5X8X12-XL	Suitable inner rings IR

Characteristics

-  Radial load
-  Grease Lubrication
-  Oil Lubrication
-  Not sealed
-  Small design envelope