

**BK0910** [↗](#)

Drawn cup needle roller bearing closed end

Drawn cup needle roller bearings with closed end BK, to DIN 618/ISO 3245

Technical information

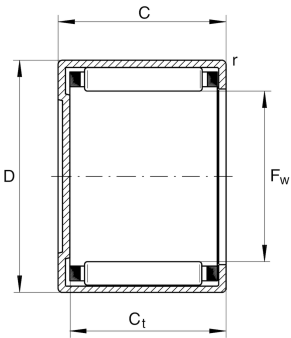

Your current product variant

Lubricant	Without
Lubrication hole	Without
Coating	Without
Sealing	Without

Main Dimensions & Performance Data

F_w	9 mm	Under roller diameter
D	13 mm	Outside diameter
C	10 mm	Width, outer ring
C_r	4.250 N	Basic dynamic load rating, radial
C_{0r}	4.650 N	Basic static load rating, radial
C_{ur}	610 N	Fatigue load limit, radial
n_G Grease	16.000 1/min	Limiting speed for grease lubrication
n_G	26.500 1/min	Limiting speed
n_{gr}	20.600 1/min	Reference speed
$\approx m$	4,3 g	Weight

Dimensions

r_{min}	0,4 mm	Minimum chamfer dimension
C_{tmin}	8,4 mm	Minimum width to base of drawn cup with closed end



Temperature range

T_{\min}	-30 °C	Operating temperature min.
T_{\max}	140 °C	Operating temperature max.

Additional information

GR9X13X3	Sealing ring
G9X13X3	Sealing ring 2
IR6X9X12-XL	Suitable inner rings IR

Characteristics

-  Radial load
-  Grease Lubrication
-  Oil Lubrication
-  Not sealed
-  Small design envelope