**BK3026**

## Drawn cup needle roller bearing closed end

Drawn cup needle roller bearings with closed end BK, to DIN 618/ISO 3245

## Technical information

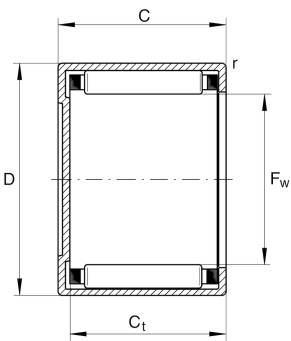

## Your current product variant

Lubricant	Without
Lubrication hole	Without
Coating	Without
Sealing	Without

## Main Dimensions &amp; Performance Data

$F_w$	30 mm	Under roller diameter
D	37 mm	Outside diameter
C	26 mm	Width, outer ring
$C_r$	28.000 N	Basic dynamic load rating, radial
$C_{0r}$	54.000 N	Basic static load rating, radial
$C_{ur}$	7.600 N	Fatigue load limit, radial
$n_G$ Grease	5.200 1/min	Limiting speed for grease lubrication
$n_G$	8.600 1/min	Limiting speed
$n_{gr}$	6.200 1/min	Reference speed
$\approx m$	58 g	Weight

## Dimensions

$r_{min}$	0,8 mm	Minimum chamfer dimension
$C_{tmin}$	23,3 mm	Minimum width to base of drawn cup with closed end







### Temperature range

$T_{min}$	-30 °C	Operating temperature min.
$T_{max}$	140 °C	Operating temperature max.

### Additional information

SD30X37X4	Sealing ring
G30X37X4	Sealing ring 2
LR25X30X26,5	Suitable inner rings LR
IR25X30X26,5-XL	Suitable inner rings IR

### Characteristics

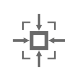
-  Radial load
-  Grease Lubrication
-  Oil Lubrication
-  Not sealed
-  Small design envelope