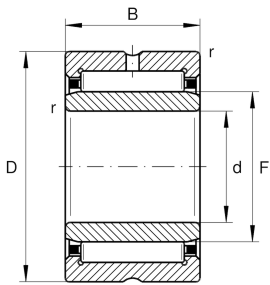

**NKI45/35** [↗](#)

Needle roller bearing

Needle roller bearing NKI, single row, with inner ring, outer ring with 2 bords

Technical information

**Your current product variant**

Cage	Standard	
Radial internal clearance	CN (Group N)	Normal internal clearance
Coating	Without	

Main Dimensions & Performance Data

d	45 mm	Bore diameter
D	62 mm	Outside diameter
B	35 mm	Width
C_r	50.000 N	Basic dynamic load rating, radial
C_{0r}	106.000 N	Basic static load rating, radial
C_{ur}	15.800 N	Fatigue load limit, radial
n_G	9.200 1/min	Limiting speed
n_{gr}	5.300 1/min	Reference speed
$\approx m$	0,322 kg	Weight

Dimensions

F	50 mm	Raceway diameter inner ring
r_{min}	0,6 mm	Minimum chamfer dimension
s	2 mm	Axial displacement

Temperature range

T_{min}	-30 °C	Operating temperature min.
T_{max}	120 °C	Operating temperature max.



Characteristics

-  Radial load
-  Grease Lubrication
-  Oil Lubrication
-  Not sealed
-  Small design envelope