

**NA6906-IS1-XL**

Needle roller bearing

Needle roller bearing NA69...-XL, single row,
with inner ring, outer ring with 2 bords

X-life

Technical information

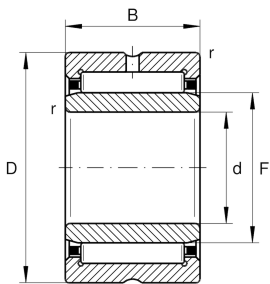

Your current product variant

Cage	Standard	
Radial internal clearance	CN (Group N)	Normal internal clearance
Tolerance class	PN	Normal (DIN 620-2)
Lubrication hole	IS1	IS1
Coating	Without	
Lubricant	Without	

Main Dimensions & Performance Data

d	30 mm	Bore diameter
D	47 mm	Outside diameter
B	30 mm	Width
C_r	49.000 N	Basic dynamic load rating, radial
C_{0r}	71.000 N	Basic static load rating, radial
C_{ur}	13.100 N	Fatigue load limit, radial
n_G	12.600 1/min	Limiting speed
n_{gr}	6.300 1/min	Reference speed
$\approx m$	0,182 kg	Weight



Dimensions

F	35 mm	Raceway diameter inner ring
r _{min}	0,3 mm	Minimum chamfer dimension
s	1 mm	Axial displacement

Temperature range

T _{min}	-30 °C	Operating temperature min.
T _{max}	120 °C	Operating temperature max.

Characteristics

-  Radial load
-  Grease Lubrication
-  Oil Lubrication
-  Not sealed
-  Small design envelope