**NKI45/35-TV-IS1-XL-C3** [↗](#)

Needle roller bearing

Needle roller bearings NKI, light series

X-life

Technical information

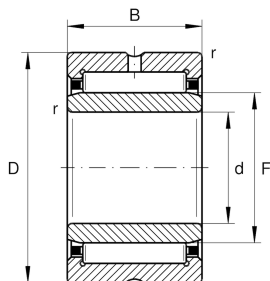
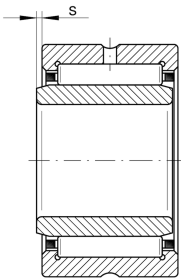

Your current product variant

Cage	TV	Plastic Cage made from PA66
Radial internal clearance	C3 (Group 3)	Internal clearance larger than CN
Tolerance class	PN	Normal (PN)
Lubrication hole	IS1	IS1
Coating	Without	
Lubricant	Without	

Main Dimensions & Performance Data

d	45 mm	Bore diameter
D	62 mm	Outside diameter
B	35 mm	Width
C _r	67.000 N	Basic dynamic load rating, radial
C _{0r}	132.000 N	Basic static load rating, radial
C _{ur}	24.300 N	Fatigue load limit, radial
n _G	9.200 1/min	Limiting speed
n _{gr}	4.950 1/min	Reference speed
≈m	307 g	Weight



Dimensions

F	50 mm	Raceway diameter inner ring
r _{min}	0,6 mm	Minimum chamfer dimension
s	2 mm	Axial displacement

Temperature range

T _{min}	-30 °C	Operating temperature min.
T _{max}	120 °C	Operating temperature max.

Characteristics

-  Radial load
-  Grease Lubrication
-  Oil Lubrication
-  Not sealed
-  Small design envelope