

Technical information

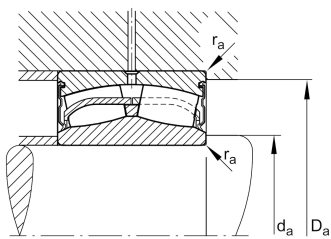
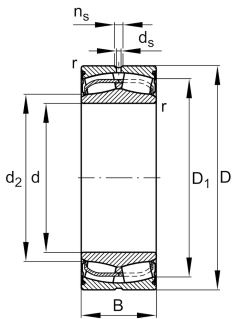

Your current product variant

Design	BE	With lose center lip ring
Bore type	Z	Cylindrical
Cage	JPB	Sheet metal cage
Radial internal clearance	C4 (Group 4)	Internal clearance larger than C3
Relubrication facility	H40	Without lubricating groove and holes
Sealing	2VSR	Seals on both sides, high temperature

Main Dimensions & Performance Data

d	130 mm	Bore diameter
D	200 mm	Outside diameter
B	69 mm	Width
C_r	570.000 N	Basic dynamic load rating, radial
C_{0r}	860.000 N	Basic static load rating, radial
C_{ur}	103.000 N	Fatigue load limit, radial
n_G	780 1/min	Limiting speed
$\approx m$	7,807 kg	Weight



Mounting dimensions

$d_{a \min}$	138,8 mm	Minimum diameter shaft shoulder
$D_{a \max}$	191,2 mm	Maximum diameter of housing shoulder
$r_{a \max}$	2 mm	Maximum recess radius

Dimensions

r_{\min}	2 mm	Minimum chamfer dimension
D_1	187,2 mm	Bore diameter outer ring
d_2	142,1 mm	Raceway diameter of the inner ring







Temperature range

T_{\min}	-30 °C	Operating temperature min.
T_{\max}	180 °C	Operating temperature max.

Calculation factors

e	0,31	Limiting value of F_a/F_r for the applicability of diff. Values of factors X and Y
Y_1	2,21	Dynamic axial load factor
Y_2	3,29	Dynamic axial load factor
Y_0	2,16	Static axial load factor

Characteristics

	Radial load
	Axial load in one direction
	Axial load in two directions
	Lifetime lubrication, freedom from maintenance
	Grease Lubrication
	Sealed on both sides
	Static angular error and misalignment
	Dynamic angular error and misalignment