



FAG

22217-E1A-XL-M

Spherical Roller Bearing

Spherical roller bearing 222...-E1A-XL-M,
symmetric 2 outer ribs

X-life

Technical information



Your current product variant

Design	E1A	Without central rip
Bore type	Z	Cylindrical
Cage	M	Brass Cage
Radial internal clearance	CN (Group N)	Normal internal clearance
Relubrication facility	Standard	

Main Dimensions & Performance Data

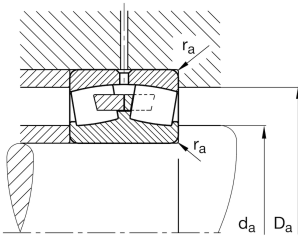

d	85 mm	Bore diameter
D	150 mm	Outside diameter
B	36 mm	Width
C_r	305.000 N	Basic dynamic load rating, radial
C_{0r}	325.000 N	Basic static load rating, radial
C_{ur}	39.000 N	Fatigue load limit, radial
n_G	5.700 1/min	Limiting speed
n_{gr}	3.450 1/min	Reference speed
m	2,605 kg	Weight



Mounting dimensions

$d_{a \min}$	96 mm	Minimum diameter shaft shoulder
$D_{a \max}$	139 mm	Maximum diameter of housing shoulder
$r_{a \max}$	2 mm	Maximum recess radius
$d_{a \max}$	99 mm	Maximum diameter of shaft shoulder
$d_{b \min}$	91 mm	Minimum cavity diameter of the sleeve
$B_{a \min}$	12 mm	Minimum cavity width of the sleeve

Dimensions

r_{\min}	2 mm	Minimum chamfer dimension
D_1	135,4 mm	Bore diameter outer ring
d_2	99,7 mm	Raceway diameter of the inner ring
d_s	3,2 mm	Diameter lubrication hole
n_s	6,5 mm	Width of lubricating groove

Temperature range

T_{\min}	-30 °C	Operating temperature min.
T_{\max}	200 °C	Operating temperature max.

Calculation factors

e	0,22	Limiting value of F_a/F_r for the applicability of diff. Values of factors X and Y
Y_1	3,04	Dynamic axial load factor
Y_2	4,53	Dynamic axial load factor
Y_0	2,97	Static axial load factor

Additional information

H317	Adapter sleeve
AHX317	Withdrawal sleeve



Characteristics



Radial load



Axial load in one direction



Axial load in two directions



Grease Lubrication



Oil Lubrication



Static angular error and misalignment