

**FAG****51110**

Axial deep groove ball bearing

Axial deep groove ball bearing 511, single direction, steel sheet metal cage

## Technical information

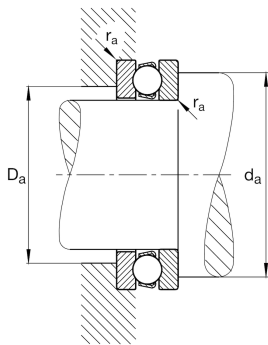

## Your current product variant

Cage	JP	Steel sheet metal
Tolerance class	PN	Tolerance class PN, acc. to DIN 620
Dimensional / heat stabilization	S0	Rings dimensional stabilized up to 150°

## Main Dimensions &amp; Performance Data

d	50 mm	Inner diameter shaft washer
D	70 mm	Outer diameter housing washer
T	14 mm	Height
$C_a$	27.000 N	Basic dynamic load rating, axial
$C_{0a}$	75.000 N	Basic static load rating, axial
$C_{ua}$	3.400 N	Fatigue load limit, axial
$n_G$	6.800 1/min	Limiting speed
$n_{gr}$	5.200 1/min	Reference speed
$\approx m$	0,16 kg	Weight

## Mounting dimensions

$d_{a \min}$	62 mm	Minimum diameter shaft shoulder
$D_{a \max}$	58 mm	Maximum diameter of housing shoulder
$r_{a \max}$	0,6 mm	Maximum filled radius



### Dimensions

$r_{\min}$	0,6 mm	Minimum chamfer dimension
$D_1$	52 mm	Inner diameter housing washer
$d_1$	70 mm	Outer diameter shaft washer

### Temperature range

$T_{\min}$	-30 °C	Operating temperature min.
$T_{\max}$	150 °C	Operating temperature max.

### Calculation factors

A	0,029	Minimum load factor
---	-------	---------------------

### Characteristics

-  Axial load in one direction
-  Grease Lubrication
-  Oil Lubrication
-  Not sealed