

**FAG****511/560-MP** [↗](#)

Axial deep groove ball bearing

Axial deep groove ball bearing 511..-MP,
single direction, solid brass cage

Technical information

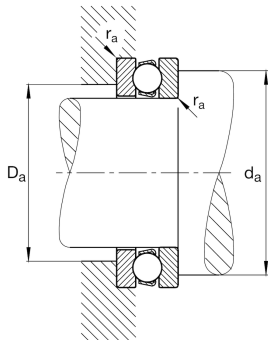

Your current product variant

Cage	MP	Solid brass cage, rolling element guided
Tolerance class	PN	Tolerance class PN, acc. to DIN 620
Dimensional / heat stabilization	S1	Rings dimensional stabilized up to 200°

Main Dimensions & Performance Data

d	560 mm	Inner diameter shaft washer
D	670 mm	Outer diameter housing washer
T	85 mm	Height
C _a	630.000 N	Basic dynamic load rating, axial
C _{0a}	4.100.000 N	Basic static load rating, axial
C _{ua}	76.000 N	Fatigue load limit, axial
n _G	740 1/min	Limiting speed
n _{gr}	550 1/min	Reference speed
m	58,1 kg	Weight

Mounting dimensions

d _{a min}	626 mm	Minimum diameter shaft shoulder
D _{a max}	604 mm	Maximum diameter of housing shoulder
r _{a max}	2,5 mm	Maximum filled radius



Dimensions

r_{\min}	3 mm	Minimum chamfer dimension
D_1	565 mm	Inner diameter housing washer
d_1	665 mm	Outer diameter shaft washer





Temperature range

T_{\min}	-30 °C	Operating temperature min.
T_{\max}	200 °C	Operating temperature max.

Calculation factors

A	87	Minimum load factor
---	----	---------------------

Characteristics

-  Axial load in one direction
-  Grease Lubrication
-  Oil Lubrication
-  Not sealed
-  Large bearing