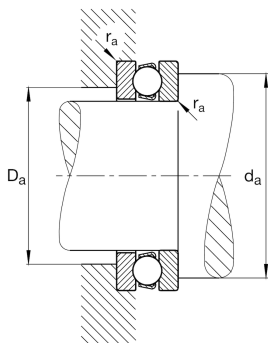

**FAG****51130-MP**

Axial deep groove ball bearing

Axial deep groove ball bearing 511..-MP,
single direction, solid brass cage

Technical information

**Your current product variant**

Cage	MP	Solid brass cage, rolling element guided
Tolerance class	PN	Tolerance class PN, acc. to DIN 620
Dimensional / heat stabilization	S0	Rings dimensional stabilized up to 150°

Main Dimensions & Performance Data

d	150 mm	Inner diameter shaft washer
D	190 mm	Outer diameter housing washer
T	31 mm	Height
C _a	109.000 N	Basic dynamic load rating, axial
C _{0a}	400.000 N	Basic static load rating, axial
C _{ua}	14.200 N	Fatigue load limit, axial
n _G	2.650 1/min	Limiting speed
n _{gr}	2.200 1/min	Reference speed
m	2,12 kg	Weight

Mounting dimensions

d _{a min}	174 mm	Minimum diameter shaft shoulder
D _{a max}	166 mm	Maximum diameter of housing shoulder
r _{a max}	1 mm	Maximum filled radius



Dimensions

r_{\min}	1 mm	Minimum chamfer dimension
D_1	152 mm	Inner diameter housing washer
d_1	188 mm	Outer diameter shaft washer

Temperature range

T_{\min}	-30 °C	Operating temperature min.
T_{\max}	150 °C	Operating temperature max.

Calculation factors

A	0,89	Minimum load factor
---	------	---------------------

Characteristics

-  Axial load in one direction
-  Grease Lubrication
-  Oil Lubrication
-  Not sealed