

**FAG****51144-MP**

Axial deep groove ball bearing

Axial deep groove ball bearing 511..-MP,  
single direction, solid brass cage

## Technical information

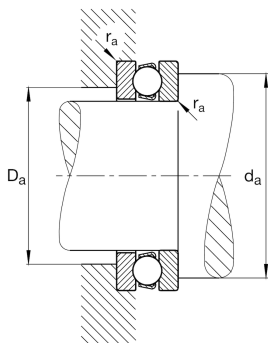

## Your current product variant

Cage	MP	Solid brass cage, rolling element guided
Tolerance class	PN	Tolerance class PN, acc. to DIN 620
Dimensional / heat stabilization	S1	Rings dimensional stabilized up to 200°

## Main Dimensions &amp; Performance Data

d	220 mm	Inner diameter shaft washer
D	270 mm	Outer diameter housing washer
T	37 mm	Height
C <sub>a</sub>	168.000 N	Basic dynamic load rating, axial
C <sub>0a</sub>	730.000 N	Basic static load rating, axial
C <sub>ua</sub>	21.300 N	Fatigue load limit, axial
n <sub>G</sub>	1.870 1/min	Limiting speed
n <sub>gr</sub>	1.600 1/min	Reference speed
m	4,508 kg	Weight

## Mounting dimensions

d <sub>a min</sub>	250 mm	Minimum diameter shaft shoulder
D <sub>a max</sub>	240 mm	Maximum diameter of housing shoulder
r <sub>a max</sub>	1 mm	Maximum filled radius



### Dimensions

$r_{\min}$	1,1 mm	Minimum chamfer dimension
$D_1$	223 mm	Inner diameter housing washer
$d_1$	267 mm	Outer diameter shaft washer

### Temperature range

$T_{\min}$	-30 °C	Operating temperature min.
$T_{\max}$	200 °C	Operating temperature max.

### Calculation factors

A	3	Minimum load factor
---	---	---------------------

### Characteristics

-  Axial load in one direction
-  Grease Lubrication
-  Oil Lubrication
-  Not sealed