

**FAG****51152-MP**

Axial deep groove ball bearing

Axial deep groove ball bearing 511..-MP,  
single direction, solid brass cage

## Technical information

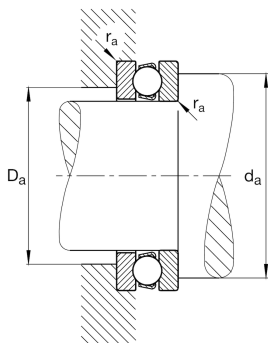

## Your current product variant

Cage	MP	Solid brass cage, rolling element guided
Tolerance class	PN	Normal (ISO 492:2023)
Dimensional / heat stabilization	S1	Rings dimensional stabilized up to 200°

## Main Dimensions &amp; Performance Data

d	260 mm	Inner diameter shaft washer
D	320 mm	Outer diameter housing washer
T	45 mm	Height
C <sub>a</sub>	245.000 N	Basic dynamic load rating, axial
C <sub>0a</sub>	1.070.000 N	Basic static load rating, axial
C <sub>ua</sub>	29.000 N	Fatigue load limit, axial
n <sub>G</sub>	1.560 1/min	Limiting speed
n <sub>gr</sub>	1.390 1/min	Reference speed
m	8,03 kg	Weight

## Mounting dimensions

d <sub>a min</sub>	296 mm	Minimum diameter shaft shoulder
D <sub>a max</sub>	284 mm	Maximum diameter of housing shoulder
r <sub>a max</sub>	1,5 mm	Maximum filled radius



### Dimensions

$r_{min}$	1,5 mm	Minimum chamfer dimension
$D_1$	263 mm	Inner diameter housing washer
$d_1$	317 mm	Outer diameter shaft washer





### Temperature range

$T_{min}$	-30 °C	Operating temperature min.
$T_{max}$	200 °C	Operating temperature max.

### Calculation factors

A	6,1	Minimum load factor
---	-----	---------------------

### Characteristics

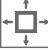
-   $F_a$  Axial load in one direction
-  Grease Lubrication
-  Oil Lubrication
-  Not sealed
-  Large bearing