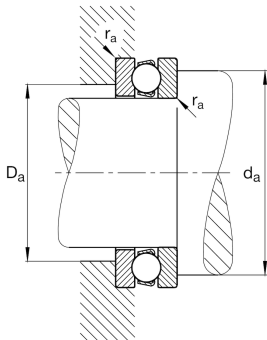

**FAG****51160-MP**

Axial deep groove ball bearing

Axial deep groove ball bearing 511..-MP,  
single direction, solid brass cage

## Technical information

**Your current product variant**

Cage	MP	Solid brass cage, rolling element guided
Tolerance class	PN	Tolerance class PN, acc. to DIN 620
Dimensional / heat stabilization	S1	Rings dimensional stabilized up to 200°

**Main Dimensions & Performance Data**

d	300 mm	Inner diameter shaft washer
D	380 mm	Outer diameter housing washer
T	62 mm	Height
C <sub>a</sub>	360.000 N	Basic dynamic load rating, axial
C <sub>0a</sub>	1.620.000 N	Basic static load rating, axial
C <sub>ua</sub>	40.000 N	Fatigue load limit, axial
n <sub>G</sub>	1.270 1/min	Limiting speed
n <sub>gr</sub>	1.190 1/min	Reference speed
m	22 kg	Weight

**Mounting dimensions**

d <sub>a min</sub>	348 mm	Minimum diameter shaft shoulder
D <sub>a max</sub>	332 mm	Maximum diameter of housing shoulder
r <sub>a max</sub>	2 mm	Maximum filled radius



### Dimensions

$r_{min}$	2 mm	Minimum chamfer dimension
$D_1$	304 mm	Inner diameter housing washer
$d_1$	376 mm	Outer diameter shaft washer



### Temperature range

$T_{min}$	-30 °C	Operating temperature min.
$T_{max}$	200 °C	Operating temperature max.

### Calculation factors

A	14	Minimum load factor
---	----	---------------------

### Characteristics

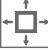
-  Axial load in one direction
-  Grease Lubrication
-  Oil Lubrication
-  Not sealed
-  Large bearing