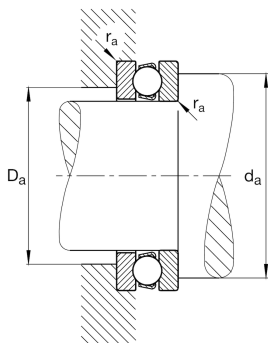

**FAG****51192-MP**

Axial deep groove ball bearing

Axial deep groove ball bearing 511..-MP,  
single direction, solid brass cage

## Technical information

**Your current product variant**

|                                  |    |  |
|----------------------------------|----|--|
| Cage                             | MP | Solid brass cage, rolling element guided |
| Tolerance class                  | PN | Tolerance class PN, acc. to DIN 620      |
| Dimensional / heat stabilization | S1 | Rings dimensional stabilized up to 200°  |

**Main Dimensions & Performance Data**

|                 |             |                                  |
|-----------------|-------------|----------------------------------|
| d               | 460 mm      | Inner diameter shaft washer      |
| D               | 560 mm      | Outer diameter housing washer    |
| T               | 80 mm       | Height                           |
| C <sub>a</sub>  | 530.000 N   | Basic dynamic load rating, axial |
| C <sub>0a</sub> | 3.100.000 N | Basic static load rating, axial  |
| C <sub>ua</sub> | 63.000 N    | Fatigue load limit, axial        |
| n <sub>G</sub>  | 880 1/min   | Limiting speed                   |
| n <sub>gr</sub> | 700 1/min   | Reference speed                  |
| m               | 41 kg       | Weight                           |

**Mounting dimensions**

|                    |        |                                      |
|--------------------|--------|--------------------------------------|
| d <sub>a min</sub> | 520 mm | Minimum diameter shaft shoulder      |
| D <sub>a max</sub> | 500 mm | Maximum diameter of housing shoulder |
| r <sub>a max</sub> | 2,1 mm | Maximum filled radius                |



### Dimensions

|            |        |                               |
|------------|--------|-------------------------------|
| $r_{\min}$ | 2,1 mm | Minimum chamfer dimension     |
| $D_1$      | 464 mm | Inner diameter housing washer |
| $d_1$      | 555 mm | Outer diameter shaft washer   |





### Temperature range

|            |        |                            |
|------------|--------|----------------------------|
| $T_{\min}$ | -30 °C | Operating temperature min. |
| $T_{\max}$ | 200 °C | Operating temperature max. |

### Calculation factors

|   |    |                     |
|---|----|---------------------|
| A | 50 | Minimum load factor |
|---|----|---------------------|

### Characteristics

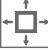
-  Axial load in one direction
-  Grease Lubrication
-  Oil Lubrication
-  Not sealed
-  Large bearing