

**FAG****51203**

Axial deep groove ball bearing

Axial deep groove ball bearing 512, single direction, steel sheet metal cage

## Technical information

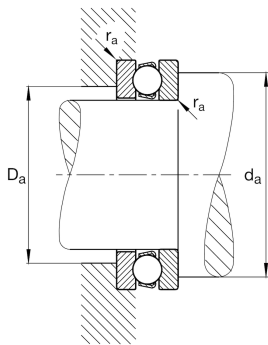
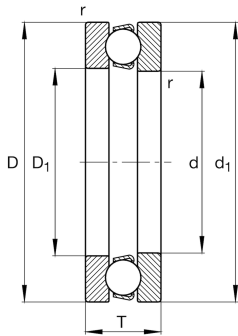

## Your current product variant

Cage	JP	Steel sheet metal
Tolerance class	PN	Tolerance class PN, acc. to DIN 620
Dimensional / heat stabilization	S0	Rings dimensional stabilized up to 150°

## Main Dimensions &amp; Performance Data

d	17 mm	Inner diameter shaft washer
D	35 mm	Outer diameter housing washer
T	12 mm	Height
C <sub>a</sub>	17.200 N	Basic dynamic load rating, axial
C <sub>0a</sub>	27.500 N	Basic static load rating, axial
C <sub>ua</sub>	1.240 N	Fatigue load limit, axial
n <sub>G</sub>	9.700 1/min	Limiting speed
n <sub>gr</sub>	13.200 1/min	Reference speed
m	0,052 kg	Weight

## Mounting dimensions

d <sub>a min</sub>	28 mm	Minimum diameter shaft shoulder
D <sub>a max</sub>	24 mm	Maximum diameter of housing shoulder
r <sub>a max</sub>	0,6 mm	Maximum fillet radius



### Dimensions

$r_{\min}$	0,6 mm	Minimum chamfer dimension
$D_1$	19 mm	Inner diameter housing washer
$d_1$	35 mm	Outer diameter shaft washer

### Temperature range

$T_{\min}$	-30 °C	Operating temperature min.
$T_{\max}$	150 °C	Operating temperature max.

### Calculation factors

A	0,004	Minimum load factor
---	-------	---------------------

### Characteristics

-  Axial load in one direction
-  Grease Lubrication
-  Oil Lubrication
-  Not sealed