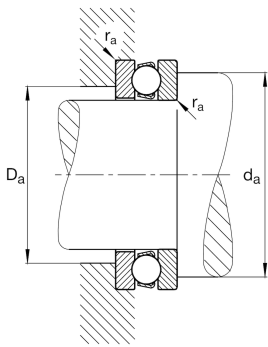

**FAG****51204**

Axial deep groove ball bearing

Axial deep groove ball bearing 512, single direction, steel sheet metal cage

## Technical information

**Your current product variant**

|                                  |    |   |
|----------------------------------|----|---|
| Cage                             | JP | Steel sheet metal                       |
| Tolerance class                  | PN | Normal (ISO 492:2023)                   |
| Dimensional / heat stabilization | S0 | Rings dimensional stabilized up to 150° |

**Main Dimensions & Performance Data**

|                 |              |                                  |
|-----------------|--------------|----------------------------------|
| d               | 20 mm        | Inner diameter shaft washer      |
| D               | 40 mm        | Outer diameter housing washer    |
| T               | 14 mm        | Height                           |
| C <sub>a</sub>  | 21.100 N     | Basic dynamic load rating, axial |
| C <sub>0a</sub> | 37.500 N     | Basic static load rating, axial  |
| C <sub>ua</sub> | 1.700 N      | Fatigue load limit, axial        |
| n <sub>G</sub>  | 8.500 1/min  | Limiting speed                   |
| n <sub>gr</sub> | 11.600 1/min | Reference speed                  |
| m               | 82 g         | Weight                           |

**Mounting dimensions**

|                    |        |                                      |
|--------------------|--------|--------------------------------------|
| d <sub>a min</sub> | 32 mm  | Minimum diameter shaft shoulder      |
| D <sub>a max</sub> | 28 mm  | Maximum diameter of housing shoulder |
| r <sub>a max</sub> | 0,6 mm | Maximum filled radius                |



### Dimensions

|            |        |                               |
|------------|--------|-------------------------------|
| $r_{\min}$ | 0,6 mm | Minimum chamfer dimension     |
| $D_1$      | 22 mm  | Inner diameter housing washer |
| $d_1$      | 40 mm  | Outer diameter shaft washer   |

### Temperature range

|            |        |                            |
|------------|--------|----------------------------|
| $T_{\min}$ | -30 °C | Operating temperature min. |
| $T_{\max}$ | 150 °C | Operating temperature max. |

### Calculation factors

|   |       |                     |
|---|-------|---------------------|
| A | 0,007 | Minimum load factor |
|---|-------|---------------------|

### Characteristics

-  Axial load in one direction
-  Grease Lubrication
-  Oil Lubrication
-  Not sealed