

**FAG****51207**

Axial deep groove ball bearing

Axial deep groove ball bearing 512, single direction, steel sheet metal cage

Technical information

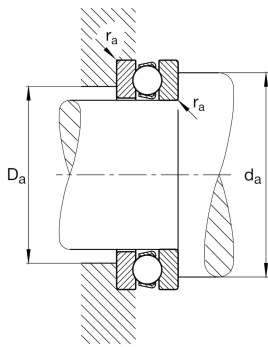

Your current product variant

| | | |
|----------------------------------|----|---|
| Cage | JP | Steel sheet metal |
| Tolerance class | PN | Normal (ISO 492:2023) |
| Dimensional / heat stabilization | S0 | Rings dimensional stabilized up to 150° |

Main Dimensions & Performance Data

| | | |
|-------------|-------------|----------------------------------|
| d | 35 mm | Inner diameter shaft washer |
| D | 62 mm | Outer diameter housing washer |
| T | 18 mm | Height |
| C_a | 35.500 N | Basic dynamic load rating, axial |
| C_{0a} | 67.000 N | Basic static load rating, axial |
| C_{ua} | 3.100 N | Fatigue load limit, axial |
| n_G | 6.000 1/min | Limiting speed |
| n_{gr} | 8.000 1/min | Reference speed |
| $\approx m$ | 220 g | Weight |

Mounting dimensions

| | | |
|--------------|-------|--------------------------------------|
| $d_{a \min}$ | 51 mm | Minimum diameter shaft shoulder |
| $D_{a \max}$ | 46 mm | Maximum diameter of housing shoulder |
| $r_{a \max}$ | 1 mm | Maximum filled radius |



Dimensions

| | | |
|------------|-------|-------------------------------|
| r_{\min} | 1 mm | Minimum chamfer dimension |
| D_1 | 37 mm | Inner diameter housing washer |
| d_1 | 62 mm | Outer diameter shaft washer |

Temperature range

| | | |
|------------|--------|----------------------------|
| T_{\min} | -30 °C | Operating temperature min. |
| T_{\max} | 150 °C | Operating temperature max. |

Calculation factors

| | | |
|---|-------|---------------------|
| A | 0,028 | Minimum load factor |
|---|-------|---------------------|

Characteristics

-  Axial load in one direction
-  Grease Lubrication
-  Oil Lubrication
-  Not sealed