

**FAG****51212**

Axial deep groove ball bearing

Axial deep groove ball bearing 512, single direction, steel sheet metal cage

## Technical information

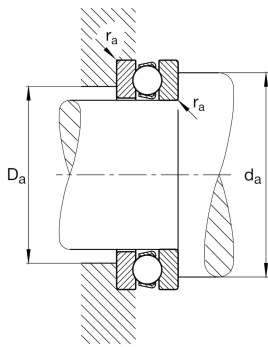

## Your current product variant

Cage	JP	Steel sheet metal
Tolerance class	PN	Tolerance class PN, acc. to DIN 620
Dimensional / heat stabilization	S0	Rings dimensional stabilized up to 150°

## Main Dimensions &amp; Performance Data

d	60 mm	Inner diameter shaft washer
D	95 mm	Outer diameter housing washer
T	26 mm	Height
$C_a$	62.000 N	Basic dynamic load rating, axial
$C_{0a}$	139.000 N	Basic static load rating, axial
$C_{ua}$	6.300 N	Fatigue load limit, axial
$n_G$	4.200 1/min	Limiting speed
$n_{gr}$	5.300 1/min	Reference speed
$\approx m$	0,65 kg	Weight

## Mounting dimensions

$d_{a \min}$	81 mm	Minimum diameter shaft shoulder
$D_{a \max}$	74 mm	Maximum diameter of housing shoulder
$r_{a \max}$	1 mm	Maximum fillet radius



### Dimensions

$r_{\min}$	1 mm	Minimum chamfer dimension
$D_1$	62 mm	Inner diameter housing washer
$d_1$	95 mm	Outer diameter shaft washer

### Temperature range

$T_{\min}$	-30 °C	Operating temperature min.
$T_{\max}$	150 °C	Operating temperature max.

### Calculation factors

A	0,12	Minimum load factor
---	------	---------------------

### Characteristics

-  Axial load in one direction
-  Grease Lubrication
-  Oil Lubrication
-  Not sealed