

**FAG****51218**

Axial deep groove ball bearing

Axial deep groove ball bearing 512, single direction, steel sheet metal cage

Technical information

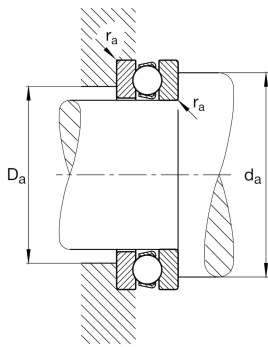
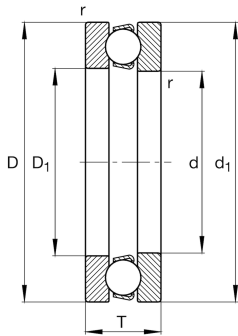

Your current product variant

Cage	JP	Steel sheet metal
Tolerance class	PN	Tolerance class PN, acc. to DIN 620
Dimensional / heat stabilization	S0	Rings dimensional stabilized up to 150°

Main Dimensions & Performance Data

d	90 mm	Inner diameter shaft washer
D	135 mm	Outer diameter housing washer
T	35 mm	Height
C _a	119.000 N	Basic dynamic load rating, axial
C _{0a}	300.000 N	Basic static load rating, axial
C _{ua}	13.000 N	Fatigue load limit, axial
n _G	2.900 1/min	Limiting speed
n _{gr}	3.750 1/min	Reference speed
m	1,682 kg	Weight

Mounting dimensions

d _{a min}	117 mm	Minimum diameter shaft shoulder
D _{a max}	108 mm	Maximum diameter of housing shoulder
r _{a max}	1 mm	Maximum filled radius



Dimensions

r_{min}	1,1 mm	Minimum chamfer dimension
D_1	93 mm	Inner diameter housing washer
d_1	135 mm	Outer diameter shaft washer

Temperature range

T_{min}	-30 °C	Operating temperature min.
T_{max}	150 °C	Operating temperature max.

Calculation factors

A	0,54	Minimum load factor
---	------	---------------------

Characteristics

-  Axial load in one direction
-  Grease Lubrication
-  Oil Lubrication
-  Not sealed