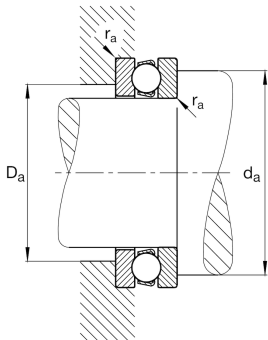
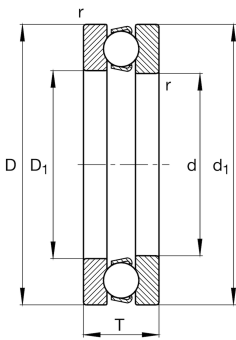

**FAG****51244-MP**

Axial deep groove ball bearing

Axial deep groove ball bearing 512...-MP,
single direction, solid brass cage

Technical information

**Your current product variant**

Cage	MP	Solid brass cage, rolling element guided
Tolerance class	PN	Normal (ISO 492:2023)
Dimensional / heat stabilization	S1	Rings dimensional stabilized up to 200°

Main Dimensions & Performance Data

d	220 mm	Inner diameter shaft washer
D	300 mm	Outer diameter housing washer
T	63 mm	Height
C _a	335.000 N	Basic dynamic load rating, axial
C _{0a}	1.330.000 N	Basic static load rating, axial
C _{ua}	37.500 N	Fatigue load limit, axial
n _G	1.420 1/min	Limiting speed
n _{gr}	1.690 1/min	Reference speed
m	13 kg	Weight

Mounting dimensions

d _{a min}	268 mm	Minimum diameter shaft shoulder
D _{a max}	252 mm	Maximum diameter of housing shoulder
r _{a max}	2 mm	Maximum filled radius



Dimensions

r_{\min}	2 mm	Minimum chamfer dimension
D_1	224 mm	Inner diameter housing washer
d_1	295 mm	Outer diameter shaft washer



Temperature range

T_{\min}	-30 °C	Operating temperature min.
T_{\max}	200 °C	Operating temperature max.

Calculation factors

A	9,6	Minimum load factor
---	-----	---------------------

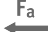
Characteristics

-  Axial load in one direction
-  Grease Lubrication
-  Oil Lubrication
-  Not sealed