

**FAG****51314**

Axial deep groove ball bearing

Axial deep groove ball bearing 513, single direction, steel sheet metal cage

Technical information

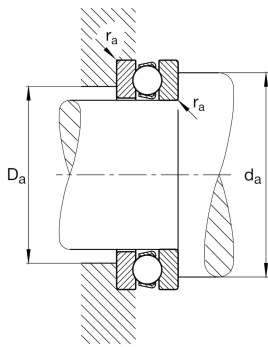
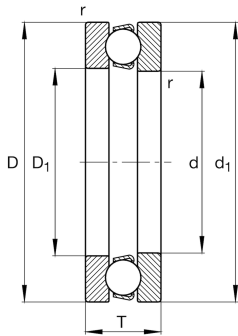

Your current product variant

Cage	JP	Steel sheet metal
Tolerance class	PN	Tolerance class PN, acc. to DIN 620
Dimensional / heat stabilization	S0	Rings dimensional stabilized up to 150°

Main Dimensions & Performance Data

d	70 mm	Inner diameter shaft washer
D	125 mm	Outer diameter housing washer
T	40 mm	Height
C_a	134.000 N	Basic dynamic load rating, axial
C_{0a}	290.000 N	Basic static load rating, axial
C_{ua}	13.300 N	Fatigue load limit, axial
n_G	2.750 1/min	Limiting speed
n_{gr}	4.950 1/min	Reference speed
$\approx m$	1,977 kg	Weight

Mounting dimensions

$d_{a \min}$	103 mm	Minimum diameter shaft shoulder
$D_{a \max}$	92 mm	Maximum diameter of housing shoulder
$r_{a \max}$	1 mm	Maximum fillet radius



Dimensions

r_{\min}	1,1 mm	Minimum chamfer dimension
D_1	72 mm	Inner diameter housing washer
d_1	125 mm	Outer diameter shaft washer

Temperature range

T_{\min}	-30 °C	Operating temperature min.
T_{\max}	150 °C	Operating temperature max.

Calculation factors

A	0,51	Minimum load factor
---	------	---------------------

Characteristics

-  Axial load in one direction
-  Grease Lubrication
-  Oil Lubrication
-  Not sealed