

**FAG****51316**

Axial deep groove ball bearing

Axial deep groove ball bearing 513, single direction, steel sheet metal cage

## Technical information

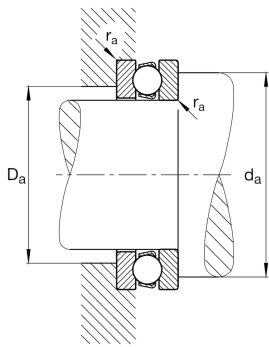
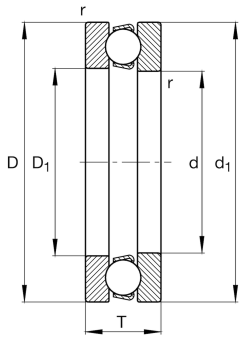

## Your current product variant

Cage	JP	Steel sheet metal
Tolerance class	PN	Tolerance class PN, acc. to DIN 620
Dimensional / heat stabilization	S0	Rings dimensional stabilized up to 150°

## Main Dimensions &amp; Performance Data

d	80 mm	Inner diameter shaft washer
D	140 mm	Outer diameter housing washer
T	44 mm	Height
$C_a$	160.000 N	Basic dynamic load rating, axial
$C_{0a}$	360.000 N	Basic static load rating, axial
$C_{ua}$	15.500 N	Fatigue load limit, axial
$n_G$	2.460 1/min	Limiting speed
$n_{gr}$	4.450 1/min	Reference speed
$\approx m$	2,667 kg	Weight

## Mounting dimensions

$d_{a \min}$	116 mm	Minimum diameter shaft shoulder
$D_{a \max}$	104 mm	Maximum diameter of housing shoulder
$r_{a \max}$	1,5 mm	Maximum filled radius



### Dimensions

$r_{\min}$	1,5 mm	Minimum chamfer dimension
$D_1$	82 mm	Inner diameter housing washer
$d_1$	140 mm	Outer diameter shaft washer





### Temperature range

$T_{\min}$	-30 °C	Operating temperature min.
$T_{\max}$	150 °C	Operating temperature max.

### Calculation factors

A	0,79	Minimum load factor
---	------	---------------------

### Characteristics

-  Axial load in one direction
-  Grease Lubrication
-  Oil Lubrication
-  Not sealed