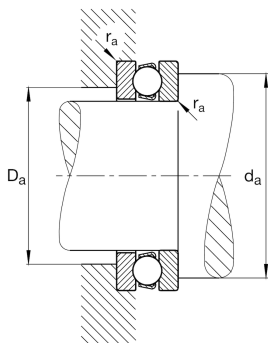

**FAG****51322-MP**

Axial deep groove ball bearing

Axial deep groove ball bearing 513...MP,  
single direction, solid brass cage

## Technical information

**Your current product variant**

|                                  |    |  |
|----------------------------------|----|--|
| Cage                             | MP | Solid brass cage, rolling element guided |
| Tolerance class                  | PN | Normal (ISO 492:2023)                    |
| Dimensional / heat stabilization | S0 | Rings dimensional stabilized up to 150°  |

**Main Dimensions & Performance Data**

|                 |             |                                  |
|-----------------|-------------|----------------------------------|
| d               | 110 mm      | Inner diameter shaft washer      |
| D               | 190 mm      | Outer diameter housing washer    |
| T               | 63 mm       | Height                           |
| C <sub>a</sub>  | 280.000 N   | Basic dynamic load rating, axial |
| C <sub>0a</sub> | 740.000 N   | Basic static load rating, axial  |
| C <sub>ua</sub> | 28.000 N    | Fatigue load limit, axial        |
| n <sub>G</sub>  | 1.790 1/min | Limiting speed                   |
| n <sub>gr</sub> | 3.400 1/min | Reference speed                  |
| m               | 7,817 kg    | Weight                           |

**Mounting dimensions**

|                    |        |                                      |
|--------------------|--------|--------------------------------------|
| d <sub>a min</sub> | 158 mm | Minimum diameter shaft shoulder      |
| D <sub>a max</sub> | 142 mm | Maximum diameter of housing shoulder |
| r <sub>a max</sub> | 2 mm   | Maximum filled radius                |



### Dimensions

|            |        |                               |
|------------|--------|-------------------------------|
| $r_{\min}$ | 2 mm   | Minimum chamfer dimension     |
| $D_1$      | 113 mm | Inner diameter housing washer |
| $d_1$      | 187 mm | Outer diameter shaft washer   |

### Temperature range

|            |        |                            |
|------------|--------|----------------------------|
| $T_{\min}$ | -30 °C | Operating temperature min. |
| $T_{\max}$ | 150 °C | Operating temperature max. |

### Calculation factors

|   |   |                     |
|---|---|---------------------|
| A | 3 | Minimum load factor |
|---|---|---------------------|

### Characteristics

-  Axial load in one direction
-  Grease Lubrication
-  Oil Lubrication
-  Not sealed