

**FAG****51406**

Axial deep groove ball bearing

Axial deep groove ball bearing 514, single direction, steel sheet metal cage

## Technical information

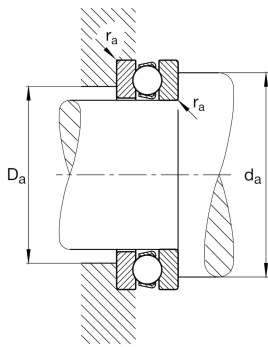

## Your current product variant

Cage	JP	Steel sheet metal
Tolerance class	PN	Normal (ISO 492:2023)
Dimensional / heat stabilization	S0	Rings dimensional stabilized up to 150°

## Main Dimensions &amp; Performance Data

d	30 mm	Inner diameter shaft washer
D	70 mm	Outer diameter housing washer
T	28 mm	Height
C <sub>a</sub>	70.000 N	Basic dynamic load rating, axial
C <sub>0a</sub>	112.000 N	Basic static load rating, axial
C <sub>ua</sub>	5.200 N	Fatigue load limit, axial
n <sub>G</sub>	3.850 1/min	Limiting speed
n <sub>gr</sub>	9.100 1/min	Reference speed
m	0,491 kg	Weight

## Mounting dimensions

d <sub>a min</sub>	54 mm	Minimum diameter shaft shoulder
D <sub>a max</sub>	46 mm	Maximum diameter of housing shoulder
r <sub>a max</sub>	1 mm	Maximum fillet radius



### Dimensions

$r_{\min}$	1 mm	Minimum chamfer dimension
$D_1$	32 mm	Inner diameter housing washer
$d_1$	70 mm	Outer diameter shaft washer

### Temperature range

$T_{\min}$	-30 °C	Operating temperature min.
$T_{\max}$	150 °C	Operating temperature max.

### Calculation factors

A	0,077	Minimum load factor
---	-------	---------------------

### Characteristics

-  Axial load in one direction
-  Grease Lubrication
-  Oil Lubrication
-  Not sealed