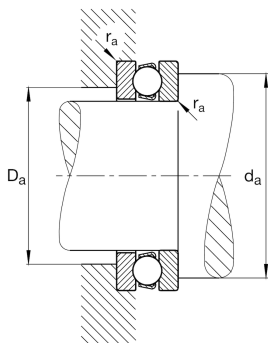

**FAG****51418-MP**

Axial deep groove ball bearing

Axial deep groove ball bearing 514...MP,  
single direction, solid brass cage

## Technical information

**Your current product variant**

Cage	MP	Solid brass cage, rolling element guided
Tolerance class	PN	Tolerance class PN, acc. to DIN 620
Dimensional / heat stabilization	S0	Rings dimensional stabilized up to 150°

**Main Dimensions & Performance Data**

d	90 mm	Inner diameter shaft washer
D	190 mm	Outer diameter housing washer
T	77 mm	Height
C <sub>a</sub>	325.000 N	Basic dynamic load rating, axial
C <sub>0a</sub>	830.000 N	Basic static load rating, axial
C <sub>ua</sub>	32.000 N	Fatigue load limit, axial
n <sub>G</sub>	1.540 1/min	Limiting speed
n <sub>gr</sub>	4.100 1/min	Reference speed
m	11,176 kg	Weight

**Mounting dimensions**

d <sub>a min</sub>	150 mm	Minimum diameter shaft shoulder
D <sub>a max</sub>	130 mm	Maximum diameter of housing shoulder
r <sub>a max</sub>	2,1 mm	Maximum filled radius



### Dimensions

$r_{\min}$	2,1 mm	Minimum chamfer dimension
$D_1$	93 mm	Inner diameter housing washer
$d_1$	187 mm	Outer diameter shaft washer

### Temperature range

$T_{\min}$	-30 °C	Operating temperature min.
$T_{\max}$	150 °C	Operating temperature max.

### Calculation factors

A	3,7	Minimum load factor
---	-----	---------------------

### Characteristics

-  Axial load in one direction
-  Grease Lubrication
-  Oil Lubrication
-  Not sealed