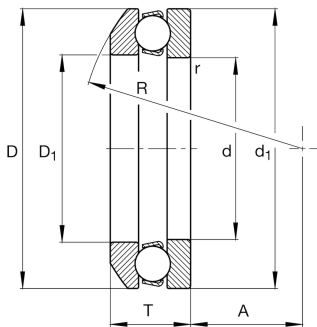
**FAG****53204** **Axial deep groove ball bearing**

Axial deep groove ball bearing 532, single direction, with spherical housing washer, steel sheet metal cage

## Technical information

**Your current product variant**

Cage	JP	Steel sheet metal
Tolerance class	PN	Normal (ISO 492:2023)
Dimensional / heat stabilization	S0	Rings dimensional stabilized up to 150°

**Main Dimensions & Performance Data**

d	20 mm	Inner diameter shaft washer
D	40 mm	Outer diameter housing washer
T	14,7 mm	Height
$C_a$	21.100 N	Basic dynamic load rating, axial
$C_{0a}$	37.500 N	Basic static load rating, axial
$C_{ua}$	1.700 N	Fatigue load limit, axial
$n_G$	8.500 1/min	Limiting speed
$n_{gr}$	11.600 1/min	Reference speed
$\approx m$	0,08 kg	Weight

**Mounting dimensions**

$d_{a \min}$	32 mm	Minimum diameter shaft shoulder
$D_{a \max}$	30 mm	Maximum diameter of housing shoulder
$r_{a \max}$	0,6 mm	Maximum filled radius



## Dimensions

$r_{\min}$	0,6 mm	Minimum chamfer dimension
$D_1$	22 mm	Inner diameter housing washer
$d_1$	40 mm	Outer diameter shaft washer
R	36 mm	Radius spherical housing washer
A	18 mm	Distance of the center point
$T_1$	17 mm	Height with seat washer
$D_2$	30 mm	Bore diameter seat washer
$D_3$	42 mm	Outside diameter seat washer
C	5 mm	Height seat washer

## Temperature range

$T_{\min}$	-30 °C	Operating temperature min.
$T_{\max}$	150 °C	Operating temperature max.

## Calculation factors

A	0,007	Minimum load factor
---	-------	---------------------

## Additional information

U204	Seat washer
------	-------------

## Characteristics

	Axial load in one direction
	Grease Lubrication
	Oil Lubrication
	Not sealed
	Static angular error and misalignment