

**FAG****53206**

## Axial deep groove ball bearing

Axial deep groove ball bearing 532, single direction, with spherical housing washer, steel sheet metal cage

## Technical information

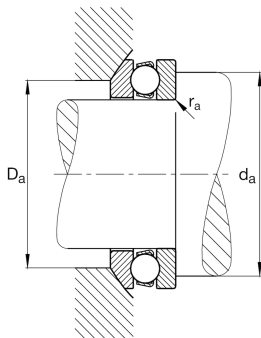
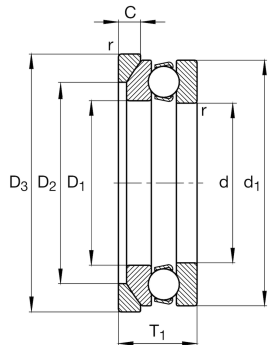

## Your current product variant

Cage	JP	Steel sheet metal
Tolerance class	PN	Normal (ISO 492:2023)
Dimensional / heat stabilization	S0	Rings dimensional stabilized up to 150°

## Main Dimensions &amp; Performance Data

d	30 mm	Inner diameter shaft washer
D	52 mm	Outer diameter housing washer
T	17,8 mm	Height
$C_a$	23.900 N	Basic dynamic load rating, axial
$C_{0a}$	46.000 N	Basic static load rating, axial
$C_{ua}$	2.100 N	Fatigue load limit, axial
$n_G$	7.300 1/min	Limiting speed
$n_{gr}$	8.600 1/min	Reference speed
$\approx m$	0,152 kg	Weight

## Mounting dimensions

$d_{a \min}$	43 mm	Minimum diameter shaft shoulder
$D_{a \max}$	42 mm	Maximum diameter of housing shoulder
$r_{a \max}$	0,6 mm	Maximum filled radius



## Dimensions

$r_{\min}$	0,6 mm	Minimum chamfer dimension
$D_1$	32 mm	Inner diameter housing washer
$d_1$	52 mm	Outer diameter shaft washer
R	45 mm	Radius spherical housing washer
A	22 mm	Distance of the center point
$T_1$	20 mm	Height with seat washer
$D_2$	42 mm	Bore diameter seat washer
$D_3$	55 mm	Outside diameter seat washer
C	5,5 mm	Height seat washer

## Temperature range

$T_{\min}$	-30 °C	Operating temperature min.
$T_{\max}$	150 °C	Operating temperature max.

## Calculation factors

A	0,014	Minimum load factor
---	-------	---------------------

## Additional information

U206

Seat washer

## Characteristics

	Axial load in one direction
	Grease Lubrication
	Oil Lubrication
	Not sealed
	Static angular error and misalignment