

**FAG****53209**

Axial deep groove ball bearing

Axial deep groove ball bearing 532, single direction, with spherical housing washer, steel sheet metal cage

## Technical information

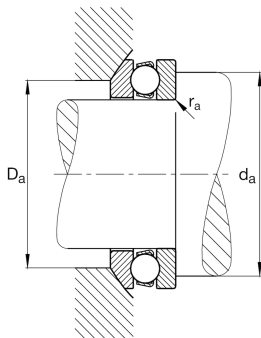

## Your current product variant

Cage	JP	Steel sheet metal
Tolerance class	PN	Tolerance class PN, acc. to DIN 620
Dimensional / heat stabilization	S0	Rings dimensional stabilized up to 150°

## Main Dimensions &amp; Performance Data

d	45 mm	Inner diameter shaft washer
D	73 mm	Outer diameter housing washer
T	21,3 mm	Height
$C_a$	39.000 N	Basic dynamic load rating, axial
$C_{0a}$	80.000 N	Basic static load rating, axial
$C_{ua}$	3.650 N	Fatigue load limit, axial
$n_G$	5.500 1/min	Limiting speed
$n_{gr}$	6.600 1/min	Reference speed
$\approx m$	0,291 kg	Weight

## Mounting dimensions

$d_{a \min}$	62 mm	Minimum diameter shaft shoulder
$D_{a \max}$	60 mm	Maximum diameter of housing shoulder
$r_{a \max}$	1 mm	Maximum filled radius



### Dimensions

$r_{\min}$	1 mm	Minimum chamfer dimension
$D_1$	47 mm	Inner diameter housing washer
$d_1$	73 mm	Outer diameter shaft washer
R	56 mm	Radius spherical housing washer
A	26 mm	Distance of the center point
$T_1$	24 mm	Height with seat washer
$D_2$	60 mm	Bore diameter seat washer
$D_3$	78 mm	Outside diameter seat washer
C	7,5 mm	Height seat washer

### Temperature range

$T_{\min}$	-30 °C	Operating temperature min.
$T_{\max}$	150 °C	Operating temperature max.

### Calculation factors

A	0,043	Minimum load factor
---	-------	---------------------

### Additional information

U209	Seat washer
------	-------------

### Characteristics

	Axial load in one direction
	Grease Lubrication
	Oil Lubrication
	Not sealed
	Static angular error and misalignment