

**FAG****53228**

Axial deep groove ball bearing

Axial deep groove ball bearing 532, single direction, with spherical housing washer, steel sheet metal cage

## Technical information

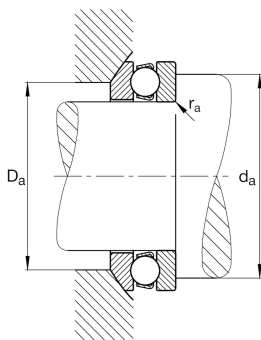
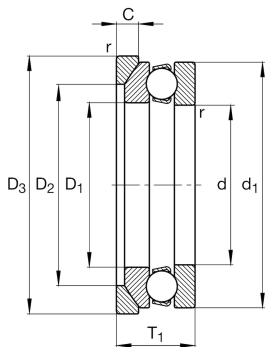

## Your current product variant

Cage	JP	Steel sheet metal
Tolerance class	PN	Tolerance class PN, acc. to DIN 620
Dimensional / heat stabilization	S0	Rings dimensional stabilized up to 150°

## Main Dimensions &amp; Performance Data

d	140 mm	Inner diameter shaft washer
D	200 mm	Outer diameter housing washer
T	48,6 mm	Height
C <sub>a</sub>	191.000 N	Basic dynamic load rating, axial
C <sub>0a</sub>	570.000 N	Basic static load rating, axial
C <sub>ua</sub>	19.800 N	Fatigue load limit, axial
n <sub>G</sub>	2.110 1/min	Limiting speed
n <sub>gr</sub>	2.700 1/min	Reference speed
≈m	4,241 kg	Weight

## Mounting dimensions

d <sub>a min</sub>	176 mm	Minimum diameter shaft shoulder
D <sub>a max</sub>	170 mm	Maximum diameter of housing shoulder
r <sub>a max</sub>	1,5 mm	Maximum filled radius



## Dimensions

$r_{\min}$	1,5 mm	Minimum chamfer dimension
$D_1$	143 mm	Inner diameter housing washer
$d_1$	197 mm	Outer diameter shaft washer
R	160 mm	Radius spherical housing washer
A	87 mm	Distance of the center point
$T_1$	55 mm	Height with seat washer
$D_2$	170 mm	Bore diameter seat washer
$D_3$	210 mm	Outside diameter seat washer
C	17 mm	Height seat washer

## Temperature range

$T_{\min}$	-30 °C	Operating temperature min.
$T_{\max}$	150 °C	Operating temperature max.

## Calculation factors

A	1,9	Minimum load factor
---	-----	---------------------

## Additional information

U228	Seat washer
------	-------------

## Characteristics

$F_a$	Axial load in one direction
	Grease Lubrication
	Oil Lubrication
	Not sealed
	Static angular error and misalignment