

**FAG****53234-MP**

## Axial deep groove ball bearing

Axial deep groove ball bearing 532...-MP, single direction, with spherical housing washer, solid brass cage

## Technical information

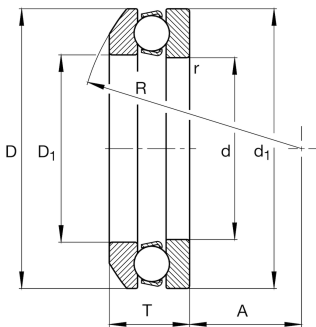

## Your current product variant

Cage	MP	Solid brass cage, rolling element guided
Tolerance class	PN	Tolerance class PN, acc. to DIN 620
Dimensional / heat stabilization	S0	Rings dimensional stabilized up to 150°

## Main Dimensions &amp; Performance Data

d	170 mm	Inner diameter shaft washer
D	240 mm	Outer diameter housing washer
T	58,7 mm	Height
$C_a$	285.000 N	Basic dynamic load rating, axial
$C_{0a}$	930.000 N	Basic static load rating, axial
$C_{ua}$	29.500 N	Fatigue load limit, axial
$n_G$	1.740 1/min	Limiting speed
$n_{gr}$	2.230 1/min	Reference speed
$\approx m$	7,92 kg	Weight

## Mounting dimensions

$d_{a \min}$	212 mm	Minimum diameter shaft shoulder
$D_{a \max}$	200 mm	Maximum diameter of housing shoulder
$r_{a \max}$	1,5 mm	Maximum filled radius



## Dimensions

$r_{\min}$	1,5 mm	Minimum chamfer dimension
$D_1$	173 mm	Inner diameter housing washer
$d_1$	237 mm	Outer diameter shaft washer
R	180 mm	Radius spherical housing washer
A	91 mm	Distance of the center point
$T_1$	65 mm	Height with seat washer
$D_2$	200 mm	Bore diameter seat washer
$D_3$	250 mm	Outside diameter seat washer
C	21,5 mm	Height seat washer

## Temperature range

$T_{\min}$	-30 °C	Operating temperature min.
$T_{\max}$	150 °C	Operating temperature max.

## Calculation factors

A	4,5	Minimum load factor
---	-----	---------------------

## Additional information

U234	Seat washer
------	-------------

## Characteristics

	Axial load in one direction
	Grease Lubrication
	Oil Lubrication
	Not sealed
	Static angular error and misalignment