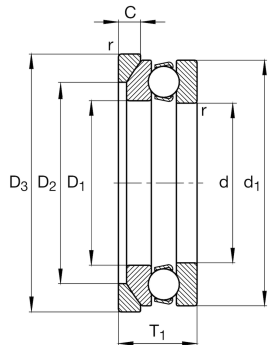

**FAG****53314** **Axial deep groove ball bearing**

Axial deep groove ball bearing 533, single direction, with spherical housing washer, steel sheet metal cage

Technical information

**Your current product variant**

Cage	JP	Steel sheet metal
Tolerance class	PN	Tolerance class PN, acc. to DIN 620
Dimensional / heat stabilization	S0	Rings dimensional stabilized up to 150°

Main Dimensions & Performance Data

d	70 mm	Inner diameter shaft washer
D	125 mm	Outer diameter housing washer
T	44,2 mm	Height
C_a	134.000 N	Basic dynamic load rating, axial
C_{0a}	290.000 N	Basic static load rating, axial
C_{ua}	13.300 N	Fatigue load limit, axial
n_G	2.750 1/min	Limiting speed
n_{gr}	4.950 1/min	Reference speed
$\approx m$	2,06 kg	Weight

Mounting dimensions

$d_{a \min}$	103 mm	Minimum diameter shaft shoulder
$D_{a \max}$	98 mm	Maximum diameter of housing shoulder
$r_{a \max}$	1 mm	Maximum filled radius



Dimensions

r_{\min}	1,1 mm	Minimum chamfer dimension
D_1	72 mm	Inner diameter housing washer
d_1	125 mm	Outer diameter shaft washer
R	100 mm	Radius spherical housing washer
A	43 mm	Distance of the center point
T_1	48 mm	Height with seat washer
D_2	98 mm	Bore diameter seat washer
D_3	130 mm	Outside diameter seat washer
C	13 mm	Height seat washer

Temperature range

T_{\min}	-30 °C	Operating temperature min.
T_{\max}	150 °C	Operating temperature max.

Calculation factors

A	0,51	Minimum load factor
---	------	---------------------

Additional information

U314	Seat washer
------	-------------

Characteristics

F_a	Axial load in one direction
	Grease Lubrication
	Oil Lubrication
	Not sealed
	Static angular error and misalignment