

**FAG****53330-MP**

Axial deep groove ball bearing

Axial deep groove ball bearing 533..-MP, single direction, with spherical housing washer, solid brass cage

Technical information

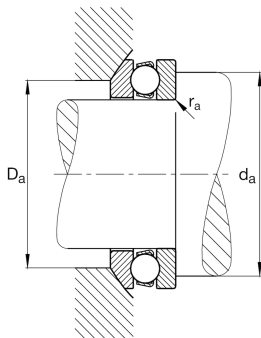

Your current product variant

Cage	MP	Solid brass cage, rolling element guided
Tolerance class	PN	Tolerance class PN, acc. to DIN 620
Dimensional / heat stabilization	S1	Rings dimensional stabilized up to 200°

Main Dimensions & Performance Data

d	150 mm	Inner diameter shaft washer
D	250 mm	Outer diameter housing washer
T	83,7 mm	Height
C_a	395.000 N	Basic dynamic load rating, axial
C_{0a}	1.330.000 N	Basic static load rating, axial
C_{ua}	43.000 N	Fatigue load limit, axial
n_G	1.340 1/min	Limiting speed
n_{gr}	2.480 1/min	Reference speed
$\approx m$	15,706 kg	Weight

Mounting dimensions

$d_{a \min}$	210 mm	Minimum diameter shaft shoulder
$D_{a \max}$	200 mm	Maximum diameter of housing shoulder
$r_{a \max}$	2,1 mm	Maximum filled radius



Dimensions

r_{\min}	2,1 mm	Minimum chamfer dimension
D_1	154 mm	Inner diameter housing washer
d_1	245 mm	Outer diameter shaft washer
R	200 mm	Radius spherical housing washer
A	89,5 mm	Distance of the center point
T_1	92 mm	Height with seat washer
D_2	200 mm	Bore diameter seat washer
D_3	260 mm	Outside diameter seat washer
C	26 mm	Height seat washer

Temperature range

T_{\min}	-30 °C	Operating temperature min.
T_{\max}	200 °C	Operating temperature max.

Calculation factors

A	9,3	Minimum load factor
---	-----	---------------------

Additional information

U330	Seat washer
------	-------------

Characteristics

F_a	Axial load in one direction
	Grease Lubrication
	Oil Lubrication
	Not sealed
	Static angular error and misalignment